



ND-Series

Cylindrical Locks





Contents

4-5	Mechanical Lock Guide
6-7	ND-Series Introduction
8	Performance Features
9	Exploded View
10	Lever Designs
11	Lever Finishes
11	Door Handing
12-15	Lock Functions
16	ND-Series Electrified Locks and Wiring Diagram
17	Cylinders and Key Systems
18	Standard Cylinders
18	Full Size Interchangeable Core
18	Primus XP High Security Cylinders
19	Small Format Interchangeable Core
20	Latches
21	Strikes
21	Rabbeted Latch and Strike Kit
21	Accessories
22	Specifications and Certifications
22	Door Preparation
23	Ordering Guidelines

Pictured here: Tubular lever shown
in 626 Satin Chrome

Cover photo: Omega lever shown
in 626 Satin Chrome



Put Your Trust in the Name You Know

For more than 85 years Schlage® has been providing innovative security solutions for schools, hospitals, hotels, condominiums and a host of other commercial buildings. Today, Schlage is at the forefront of cutting-edge technology such as wireless security systems, biometrics and CCTV. With a wide range of products, styles and finishes, Schlage has what you need no matter how demanding your project specifications may be. And we stand behind every lock we make with some of the best after-sales service in the business. It's this commitment to design, performance and technology that ensures you can stand behind our products too.

Schlage Commercial Locks



Tubular Locks



Tubular Interconnected Locks



Cylindrical Locks



Cylindrical Interconnected Locks

S-Series	S200-Series	A-Series	H-Series
GRADE 2	GRADE 2	GRADE 2	
Security Level:			
ANSI/BHMA Certified A156.2-2003 Exceeds 400,000 ANSI Cycles Light Traffic	ANSI/BHMA Certified A156.12-2005 Exceeds 400,000 ANSI Cycles Medium Traffic	ANSI/BHMA Certified A156.2-2003 Exceeds 400,000 ANSI Cycles Medium Traffic	ANSI/BHMA Certified - Exceeds 400,000 ANSI Cycles Medium Traffic
Typical Applications:			
- Interior - Retrofit	Exterior Interior New Construction Retrofit	Exterior Interior New Construction Retrofit	Exterior Interior - Retrofit
Functions Available:			
6 Functions - -	5 Functions - -	11 Functions - -	5 Functions - -
Design Options:			
8 Finishes 4 Lever Styles - 3 Decorative Options 1 Matching Rose - Tactile Warning Available	8 Finishes 4 Lever Styles - 3 Decorative Options 1 Matching Rose 1 Interior Escutcheon -	9 Finishes 1 Lever Style 4 Knob Styles 3 Decorative Options 1 Matching Rose - -	7 Finishes 1 Lever Style 2 Knobs Styles 2 Decorative Options 1 Matching Rose 1 Interior Escutcheon -
Often Used In:			
Commercial Multi-Family Office	Commercial Multi-Family Office	Commercial Healthcare Hospitality Office Retail	Commercial Govt/Military Multi-Family

Not all functions and finishes available with all products. Please consult your Ingersoll Rand representative for details.



Cylindrical Locks



Deadbolts



Cylindrical Locks



Cylindrical Locks



Mortise Locks

AL-Series	B-Series		D-Series	ND-Series	L-Series
GRADE 2	GRADE 2	GRADE 1	GRADE 1	GRADE 1	GRADE 1
Security Level:					
ANSI/BHMA Certified A156.2-2003 Exceeds 400,000 ANSI Cycles Medium Traffic	ANSI/BHMA Certified A156.5-2001 Exceeds 150,000/250,000 ANSI Cycles High Heavy Duty		ANSI/BHMA Certified A156.2-2003 Exceeds 800,000 ANSI Cycles High Traffic	ANSI/BHMA Certified A156.2-2003 Exceeds 800,000 ANSI Cycles Heavy Duty Traffic	ANSI/BHMA Certified A156.13-2005 Exceeds 1,000,000 ANSI Cycles Heavy Duty Traffic
Typical Applications:					
Exterior Interior New Construction Retrofit	Exterior - New Construction Retrofit		Exterior Interior - Retrofit	Exterior Interior New Construction Retrofit	Exterior Interior New Construction Retrofit
Functions Available:					
10 Functions - -	7 Functions	6 Functions	16 Functions 2 Electrified -	30 Functions 6 Electrified Vandlgard™ Available	53 Functions 4 Electrified Vandlgard™ Available
Design Options:					
8 Finishes 4 Lever Styles - 3 Decorative Options 1 Matching Rose - Tactile Warning Available	9 Finishes - - - - - Indicator Rose		8 Finishes - 3 Knob Styles 2 Decorative Options 1 Matching Rose - -	8 Finishes 5 Lever Styles - 4 Decorative Options 2 Matching Rose - Tactile Warning Available	10 Finishes 24 Lever Styles 2 Knob Styles 23 Decorative Options 4 Matching Roses 2 Escutcheons Tactile Warning Available
Often Used In:					
Commercial Healthcare Hospitality Office Retail	Commercial/Institutional Govt/Military Heavy Duty Residential Hospitality Office Retail		Institutional Govt/Military Hospitality Retail	Institutional Education Healthcare Office Retail	Institutional Education Healthcare Office

This chart shows the most common uses/applications and these products are often used in other applications in addition to those listed.

Rev. 12/08



Real Security is Knowing Exactly What You Want and Getting It

When you know exactly what you want, you don't want to waste time finding out whether it meets your project specifications. That's why we offer the world's largest team of hardware specification writers to help you and your clients turn your vision into reality. And when it comes to products, our commercial suiting options, wide variety of lever designs and rich selection of finishes give you the tools you need to make your projects perfect. You know what you want. With Schlage you can be sure you'll get it.

Safety, Security and Confidence

When you choose a Schlage lock you can be sure you've done the job right the first time. After all, our products are among the most durable and dependable on the market today. Our locks are easy to install, and simple to repair and maintain. That means fewer callbacks for you and total safety and security for your customers.

ND-Series

The toughest cylindrical lock for heavy-duty commercial applications.

At Schlage we know that every product you specify has to stand up to constant use and abuse without compromising security. The ND-Series gets the job done with tough, dependable ANSI Grade 1 locks designed for use in schools, hospitals, offices, retail spaces, and colleges and universities. Built for heavy duty applications, ND-Series locks are easy to service and maintain, are available with our exclusive Vandlgard® technology, and offer a wide range of styles and finishes to fit your project needs.

Pictured here: Sparta lever shown
in 626 Satin Chrome

We don't compromise on security.

The safety and security of your clients' buildings is something we take very seriously. That's why every Schlage lock and deadbolt undergoes intensive testing to determine its ANSI grade level:

- Cycle tests
- Resistance tests
- Door impact tests
- Warped door tests
- Bolt strength tests

We pay attention to these details so you can focus on creating a functional and aesthetically pleasing environment for your clients. In fact, every one of our ND-Series locks meets ANSI Grade 1 standards for safety.

ND Series

The Schlage ND Series is the toughest cylindrical lock we make. That means you get premium durability and performance in a lock that's also easy to service and maintain. And because we test our locks beyond the standards required by ANSI, you know that you're getting a product you can count on to withstand the use and abuse that come with heavy duty commercial applications.

Pictured here: Athens lever shown
in 626 Satin Chrome



Built to perform without fail.

- Tested to at least four times the 800,000-cycle ANSI Grade 1 requirement
- Exceeds ANSI A156.2, Series 4000 Grade 1 locked lever torque requirements
- The only cylindrical lock available with our exclusive Vandlgard® technology

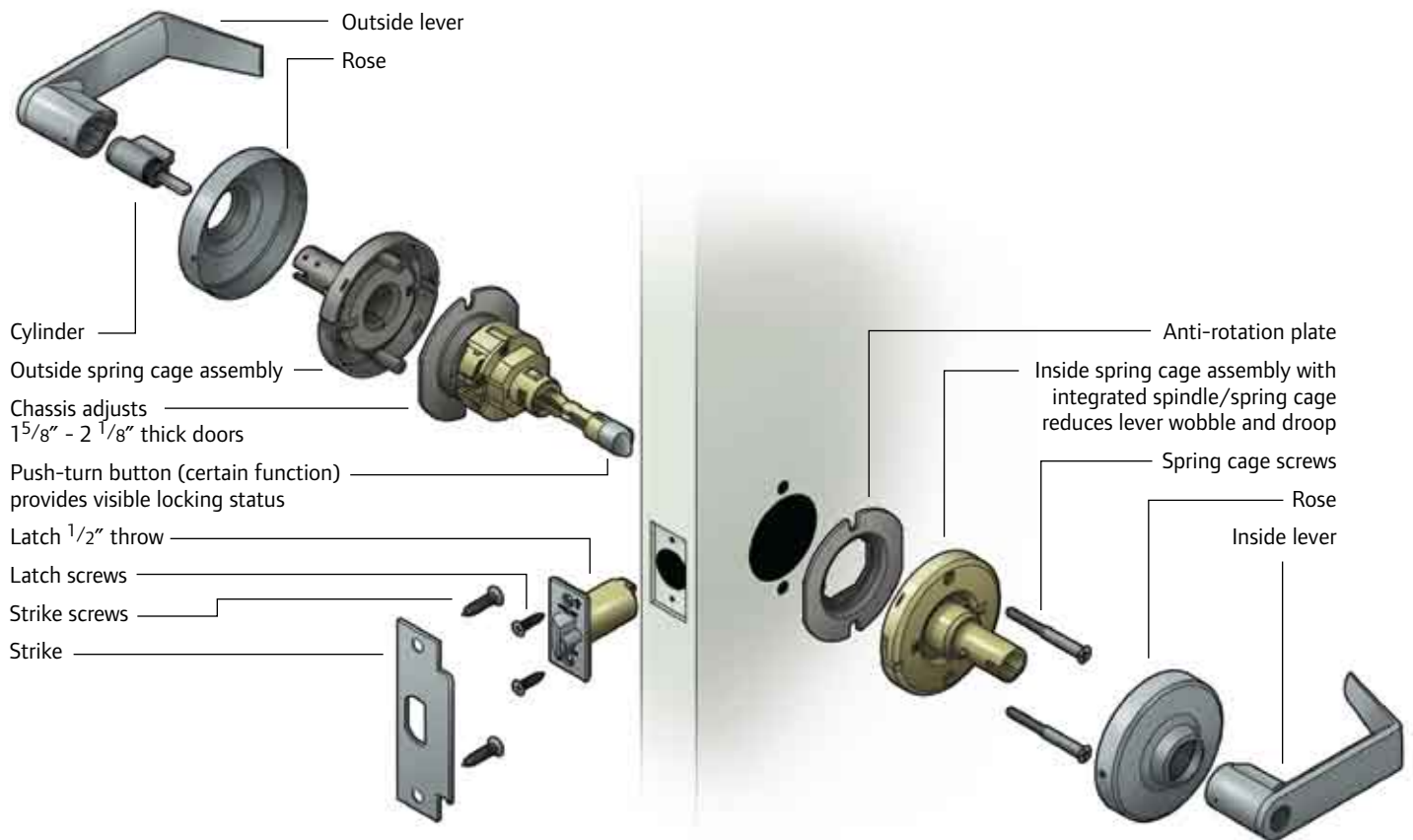

ND-Series with Vandlgard

The ND-Series Vandlgard is ideal for areas subject to abuse or anywhere vandalism is likely to be present, such as schools, universities, offices and commercial/public buildings. Vandlgard prevents damage to internal lock components caused by excessive force from hitting or standing on the lever to gain access. Vandlgard functions maintain total key system and architectural design compatibility with Schlage's regular ND-Series cylindrical locks.



Locked lever freely rotates up and down while remaining securely locked. The Vandlgard function also increases resistance to over-rotation of the lever.

Lever Designs

Athens

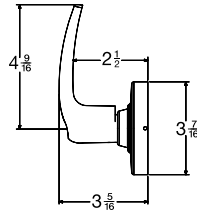

Symbol: ATH (L-Series 07)

Material: Pressure cast zinc lever; wrought brass rose



Sparta

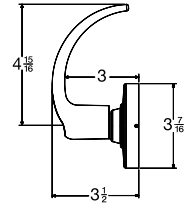

Symbol: SPA (L-Series 17)

Material: Pressure cast zinc lever; wrought brass rose



Rhodes

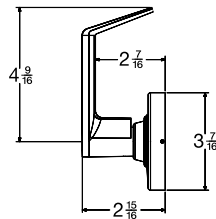

Symbol: RHO (L-Series 06)

Material: Pressure cast zinc lever; wrought brass rose



Tubular

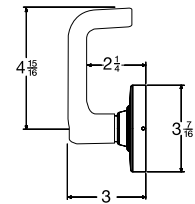

Symbol: TLR (L-Series 03)

Material: Pressure cast zinc lever; wrought brass rose



Omega

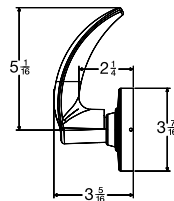
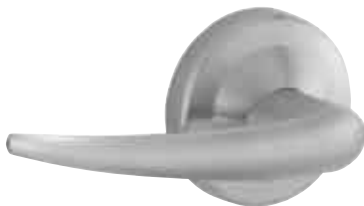

Symbol: OME (L-Series Omega)

Material: Pressure cast zinc lever; wrought brass rose



Tactile Warning

Milled

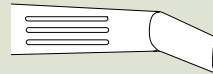

Order as follows:
8AT for Athens
8RO for Rhodes
8SP for Sparta

Knurled



Order as follows:
8TR for Tubular

Only available on outside lever, unless otherwise specified

All designs shown in 626 Satin Chrome



= Standard cylinder.



= FSIC - Full size interchangeable core option.



= SFIC - Small format interchangeable core option.



= Complies with ADA Accessibility Guidelines.



= Antimicrobial coating available on 626 finish only.



= Meets California code for 1/2" or less return to the door.



= Extended factory lead time.

Lever Finishes

								
	605 Bright Brass	606 Satin Brass	612 Satin Bronze	613 Oil Rubbed Bronze	619 Satin Nickel	625 Bright Chromium Plated	626 Satin Chromium Plated	643e Aged Bronze
ND SERIES LOCKS								
								NEW IN 2009
Athens	•	•	•	•	•	•	•	•
Omega	•	•	•	•	•	•	•	•
Rhodes	•	•	•	•	•	•	•	•
Sparta	•	•	•	•	•	•	•	•
Tubular	•	•	•	•	•	•	•	•

e = an equivalent finish to the BHMA standard.

Door Handing

All ND levers are reversible. Hand information is necessary to ensure proper cylinder orientation in keyed functions, and finish of latchbolt and strike for locks that are to be installed on reverse bevel doors. Follow the diagram to correctly determine the hand of the door.

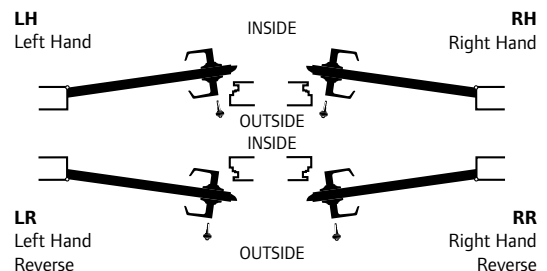

ADA-Compliant Products

In compliance with the American National Standards Institute (ANSI A117.1) and the Americans with Disabilities Act (ADA), Schlage Lock Company offers a wide selection of locks designed for the needs of the physically challenged. This act is designed to provide protection for people with disabilities.

The intent of ADA is that owners of certain types of buildings must remove barriers and provide people with disabilities with access equal to, or similar to, that available to the general public.

Product information and specifications contained in this catalog are subject to change without notice. Please consult the factory.

Lock Functions | ANSI A156.2 Series 4000 Grade 1

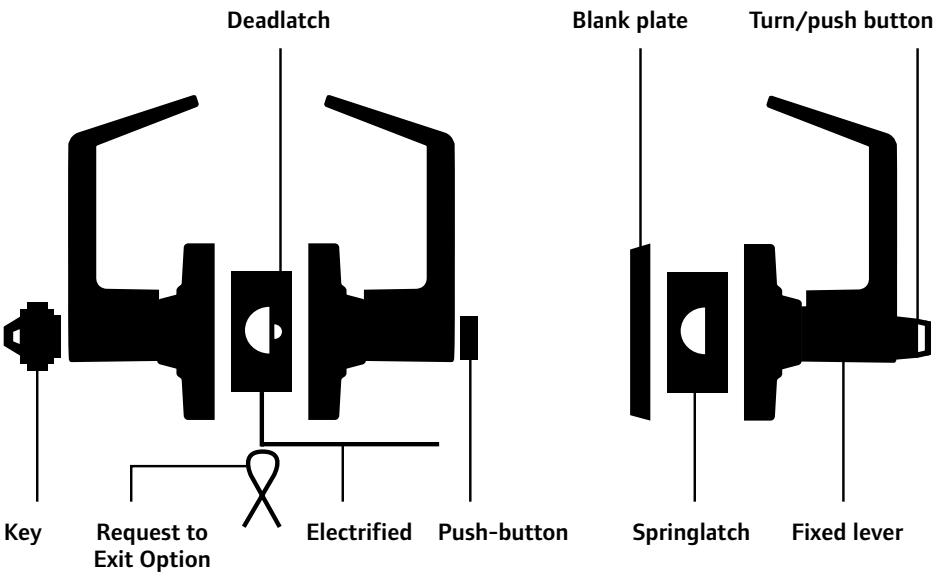

Non-Keyed Locks

SCHLAGE ANSI
ND10S F75

Passage Latch
 • Both levers always unlocked.

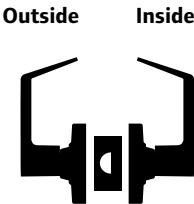

SCHLAGE ANSI
ND12D F89
Exit Lock
 • Outside lever always fixed.
 • Inside lever always unlocked.

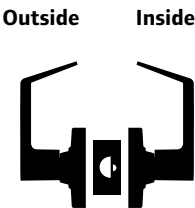

SCHLAGE ANSI
ND12DEL -
Electrically Locked (Fail Safe)
 • Outside lever continuously locked electrically.
 • Unlocked by switch or power failure.
 • Auxiliary latch deadlocks latchbolt when door is closed.
 • Inside lever always free for immediate exit.

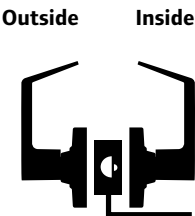

SCHLAGE ANSI
ND12DEU -
Electrically Unlocked (Fail Secure)
 • Outside lever continuously locked until unlocked by electric current.
 • Auxiliary latch deadlocks latchbolt when door is closed.
 • Inside lever is always free for immediate exit.

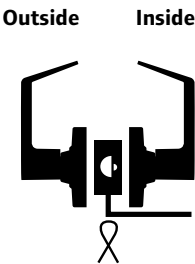

SCHLAGE ANSI
ND25D -
Exit Lock
 • Blank plate outside.
 • Inside lever always unlocked.

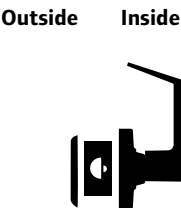

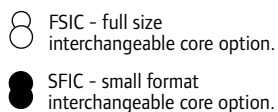
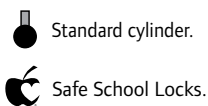

† Caution:
Double cylinder locks are a life safety hazard in times of emergency and their use is not recommended. Installation should be in accordance with existing codes only.

Keyed Locks

SCHLAGE ANSI
ND40S F76

Bath/Bedroom Privacy Lock

- Push-button locking.
- Can be opened from outside with a small screwdriver.
- Turn inside lever or close door to release button.

Outside Inside

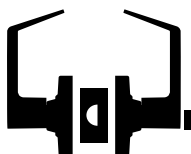

SCHLAGE ANSI
ND44S -

Hospital Privacy Lock

- Push-button locking.
- Unlocked from outside by turning emergency turn-button.
- Turn inside lever or close door to release button.

Outside Inside

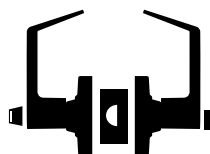

SCHLAGE ANSI
ND170

Single Dummy Trim

- Dummy trim for one side of door.
- Used for door pull or as matching inactive trim.

Outside/Inside



SCHLAGE ANSI
ND50PD F82

Entrance/Office Lock

- Push-button locking.
- Push-button locks outside lever until it is unlocked with key or by turning inside lever.

Outside Inside



SCHLAGE ANSI
ND53PD F109

Entrance Lock

- Turn/push-button locking: Pushing and turning the button locks the outside lever, requiring use of a key until the button is manually unlocked.
- Push-button locking: Pushing button locks outside lever until unlocked by key or by turning the inside lever.

Outside Inside

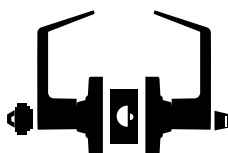

SCHLAGE ANSI
ND60PD F88

Vestibule Lock

- Latch retracted by key from outside when the outside lever is unlocked by key in inside lever.
- Inside lever is always unlocked.

Outside Inside

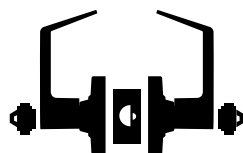

SCHLAGE ANSI
ND66PD F91

Store Lock†

- Key in either lever locks or unlocks both levers.

Outside Inside

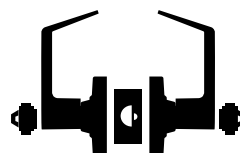

SCHLAGE ANSI
ND70PD F84

Classroom Lock

- Outside lever locked and unlocked by key.
- Inside lever always unlocked.

Outside Inside

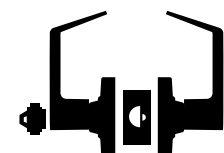

Lock Functions | ANSI A156.2 Series 4000 Grade 1

Keyed Locks (continued)

<p>SCHLAGE ANSI</p> <p>ND73PD F90</p> <p>Corridor Lock</p> <ul style="list-style-type: none"> • Locked or unlocked by key from outside. • Push-button locking from inside. • Turn inside lever or close door to release button. • When outside lever is locked by key it can only be unlocked by key. • Inside lever is always unlocked. <div> <div>Outside Inside</div> <div> </div> </div>	<p>SCHLAGE ANSI</p> <p>ND75PD -</p> <p>Classroom Security Lock</p> <ul style="list-style-type: none"> • Key in either lever locks or unlocks outside lever. • Inside lever is always unlocked. <div> <div>Outside Inside</div> <div> </div> </div>	<p>SCHLAGE ANSI</p> <p>ND80PD F86</p> <p>Storeroom Lock</p> <ul style="list-style-type: none"> • Outside lever is fixed. • Entrance by key only. • Inside lever always unlocked. <div> <div>Outside Inside</div> <div> </div> </div>	<p>SCHLAGE ANSI</p> <p>ND80PDEL -</p> <p>Electrically Locked (Fail Safe)</p> <ul style="list-style-type: none"> • Outside lever continuously locked electrically. • Unlocked by key outside or by switch or power failure. • Auxiliary latch deadlocks latchbolt when door is closed. • Inside lever always free for immediate exit. <div> <div>Outside Inside</div> <div> </div> </div>
<p>SCHLAGE ANSI</p> <p>ND80PDEU -</p> <p>Electrically Unlocked (Fail Secure)</p> <ul style="list-style-type: none"> • Outside lever continuously locked until unlocked by key or electric current. • Auxiliary latch deadlocks latchbolt when door is closed. • Inside lever always free for immediate exit. <div> <div>Outside Inside</div> <div> </div> </div>	<p>SCHLAGE ANSI</p> <p>ND82PD F87</p> <p>Institution Lock†</p> <ul style="list-style-type: none"> • Both levers are fixed. • Entrance by key in either lever. <div> <div>Outside Inside</div> <div> </div> </div>	<p>SCHLAGE ANSI</p> <p>ND85PD -</p> <p>Faculty Restroom Lock</p> <ul style="list-style-type: none"> • Outside lever is fixed. • Entrance by key only. • Push-button in inside lever activates visual occupancy indicator, allowing only emergency master key to operate. • Turn inside lever or close door to release visual occupancy indicator. • Rotation of inside spinner-button provides lock-out feature by keeping indicator thrown. <div> <div>Outside Inside</div> <div> </div> </div>	<p>SCHLAGE ANSI</p> <p>ND91PD F82</p> <p>Entrance/Office Lock</p> <ul style="list-style-type: none"> • Push-button locking. • Push-button disengages outside lever until locked with key or by turning inside lever. • Vandlgard is designed to disengage outside spindle from latch when locked. <div> <div>Outside Inside</div> <div> </div> </div>

Vandlgard Functions

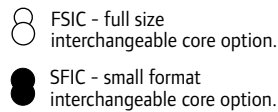
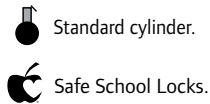

† Caution:
Double cylinder locks are a life safety hazard in times of emergency and their use is not recommended. Installation should be in accordance with existing codes only.

SCHLAGE ANSI
ND92PD F109

Entrance Lock

- Turn/push-button locking: Pushing and turning button disengages outside lever, requiring using of key until button is manually unlocked.
- Push-button locking: Pushing button disengages outside lever until unlocked by key or by turning inside lever.
- Vandlgard is designed to disengage outside spindle from latch when locked.

Outside Inside

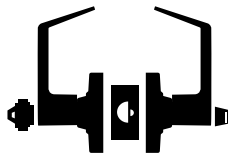

SCHLAGE ANSI
ND93PD F88

Vestibule Lock

- Latch retracted by key from outside when outside lever is disengaged by key in inside lever.
- Inside lever is always unlocked.
- Vandlgard is designed to disengage outside spindle from latch when locked.

Outside Inside



SCHLAGE ANSI
ND94PD F84

Classroom Lock

- Outside lever disengaged and unlocked by key.
- Inside lever always unlocked.
- Vandlgard is designed to disengage outside spindle from latch when locked.

Outside Inside

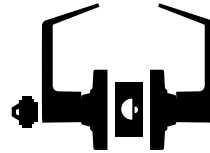

SCHLAGE ANSI
ND95PD -

Classroom Security Lock

- Key in either lever locks or unlocks outside lever.
- Inside lever is always unlocked.

Outside Inside

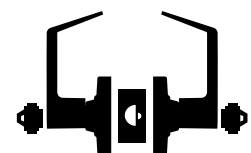

SCHLAGE ANSI
ND96PD F86

Storeroom Lock

- Outside lever always disengaged.
- Entrance by key only.
- Inside lever is always unlocked.
- Vandlgard is designed to disengage outside spindle from latch when locked.

Outside Inside



SCHLAGE ANSI
ND96PDEL -

Electrically Locked (Fail Safe)

- Outside lever continuously disengaged electrically.
- Unlocked by key outside or by switch or power failure.
- Auxiliary latch deadlocks latchbolt when door is closed.
- Inside lever always free for immediate exit.
- Vandlgard is designed to disengage outside spindle from latch when locked.

Outside Inside



SCHLAGE ANSI
ND96PDEU -

Electrically Unlocked (Fail Secure)

- Outside lever continuously disengaged until unlocked by key or electric current.
- Auxiliary latch deadlocks latchbolt when door is closed.
- Inside lever always free for immediate exit.
- Vandlgard is designed to disengage outside spindle from latch when locked.

Outside Inside



SCHLAGE ANSI
ND97PD F90

Corridor Lock

- Locked or unlocked by key from outside.
- Push-button locking from inside.
- Turning inside lever or closing door releases button.
- When outside lever is locked by key it can only be unlocked by key.
- Inside lever is always unlocked.
- Vandlgard is designed to disengage outside spindle from latch when locked.

Outside Inside

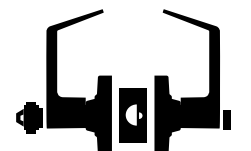

ND-Series Electrified Locks

ND-Series locks are available for electrically locking and unlocking controls for high security and fire safety applications. They are UL Listed and rated for both fire and electrical single-point locking on labeled doors. RX feature is available on ND80 and ND12 families. Switch is ready to be used in a normally open or normally closed application.

Special prep required for RX feature. See service manual for details.

Electrical Requirements

Voltage

24VAC or 24VDC

Holding Current

.15A or .35A

Operating Temperature

Maximum +151°F (+66°C)

Minimum -31°F (-33°C)

Note: All installations should be in accordance with local electrical codes.



Typical Wiring Diagram for Electrified Locks

AC Power Source – EL or EU

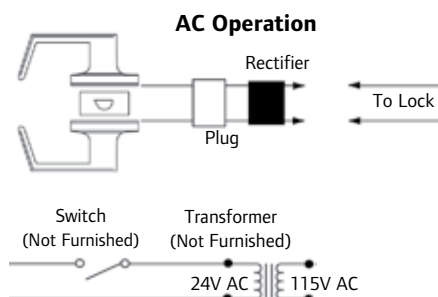

Rectifier used on AC operation unit only.
.35A @ 24V (Current requirements per lock)

DC Power Source – EL or EU

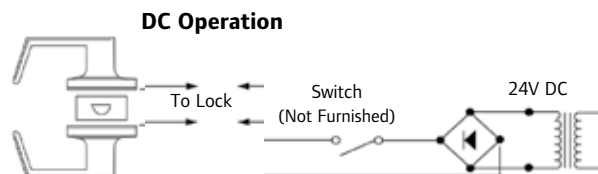

.15A @ 24V (Current requirements per lock)

AC and DC Application

Cut as close to plug as possible for DC operation.

Plug into solenoid for AC operation. Discard for DC operation.

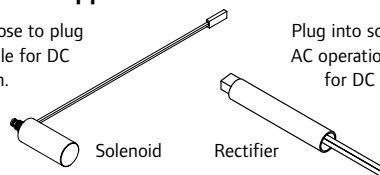

ND-Series Other Special Functions

ND30D

Patio lock

Push button locking. Turning inside lever or closing door releases button, preventing a lock-out. Inside lever always free for immediate egress. Specify per XN12-007.

ND25 x 80PD

Storeroom exit lock

Blank plate outside. Key in fixed inside lever retracts latch. Specify per XN12-005.

ND25 x 70PD

Classroom exit lock

Blank plate outside. Key locks or unlocks inside lever. Specify per XN12-004.

ND60PD

Vestibule with closed outside lever

Same as ND60 except outside lever is closed. Inside lever always free for immediate egress. Specify per XN12-001.

ND70 x 80PD

Classroom by storeroom lock

Key locks and unlocks outside lever. Key in fixed inside lever retracts latch. Specify per XN12-006.

ND72PD

Communicating Lock

Key in either lever locks and unlocks on lever. Specify per XN12-002.

ND72PD

Vandlgard communicating lock

Communicating, ND72, lock with Vandlgard. Key in either lever locks and unlocks own lever. Both inside and outside levers are clutching. Specify per XN12-003.

Cylinders and Key Systems



New and existing key systems.

If you're implementing a completely new key system Schlage can help you design a system that can grow and change along with your needs, allowing you the flexibility to upgrade your security without the need to replace all your cylinders.

EVEREST		
What it operates	What it is	
<ul style="list-style-type: none"> • Everest Primus XP cylinders • Everest Restricted Security cylinders • Everest Standard Security cylinders 	UL437 Version <ul style="list-style-type: none"> • UL437 versions provide drill and pick resistance and withstand physical attack • High security cylinders have a second set of pins for added security • Patented key control sold with various levels of geographic exclusivity • Keys operate high security, as well as restricted security or standard security cylinders • Available in standard and FSIC 	
<ul style="list-style-type: none"> • Everest Primus XP cylinders • Everest Restricted Security cylinders • Everest Standard Security cylinders 	Controlled Access <ul style="list-style-type: none"> • Patented key control sold with various levels of geographic exclusivity • High security cylinders have a second set of pins for added security and pick resistance • Keys operate high security, as well as restricted security or standard security cylinders • Available in standard and FSIC 	 EVEREST PRIMUS XP HIGH SECURITY
<ul style="list-style-type: none"> • Everest Restricted Security cylinders 	<ul style="list-style-type: none"> • Key distribution is restricted — duplication must be authorized • End user's ID numbers are stamped on all keys, enabling Schlage to identify the source of any unauthorized keys • Patent-protected keys are drop-shipped from the factory directly to an end-user specified location to guarantee exclusivity • Available in standard, SFIC and FSIC 	 EVEREST RESTRICTED SECURITY
<ul style="list-style-type: none"> • Everest Standard Security cylinders 	<ul style="list-style-type: none"> • Patented key blanks can be stored by commercial locksmiths and security dealers • Keys can be duplicated without any paperwork or signature verification • Sold only through commercial outlets • Available in standard and FSIC 	 EVEREST STANDARD SECURITY

Existing key systems.

Schlage offers two key systems that are ideal for upgrading an existing key system and regaining control over key management. Our patent-protected cylinders help prevent unauthorized duplication and can be integrated into virtually any existing system.

CLASSIC		
What it is	What it operates	
UL437 Version <ul style="list-style-type: none"> • UL437 versions provide drill and pick resistance and withstand physical attack • High security cylinders have a second set of pins for added security • Patented key control sold with various levels of geographic exclusivity • Keys operate high security, as well as restricted security or standard security cylinders • Available in standard and FSIC 	<ul style="list-style-type: none"> • Primus XP cylinders • Classic cylinders 	
Controlled Access <ul style="list-style-type: none"> • Patented key control sold with various levels of geographic exclusivity • High security cylinders have a second set of pins for added security and pick resistance • Keys operate high security, as well as restricted security or standard security cylinders • Available in standard and FSIC 	<ul style="list-style-type: none"> • Primus XP cylinders • Classic cylinders 	
 PRIMUS XP HIGH SECURITY		
 CLASSIC BASIC SECURITY	<ul style="list-style-type: none"> • Keys can be duplicated at most retail and commercial points of sale with no restrictions • Recommended only for residential applications or existing commercial systems that cannot rekey • Can be upgraded to Primus XP without rekeying the entire facility • Available in standard and FSIC 	<ul style="list-style-type: none"> • Classic cylinders

Standard Cylinders

Standard cylinders are available in Classic keyways or in patented Everest® keyways. Specify keyway to differentiate between Everest and Classic.

Example: C (Classic) vs. C123 (Everest).



Full Size Interchangeable Core 8

Schlage FSIC full size interchangeable core (IC) locksets allow immediate rekeying at the door simply by using a special control key to replace the core.



Available in all lever designs, full size interchangeable cores can be integrated into any 5 or 6-pin Schlage key.

Standard Cylinders

Number	Description
23-065	6-Pin conventional (standard)
20-765-XP	Primus XP high security
20-565-XP	Primus XP UL437 Listed high security
23-000	Hotel cylinder
N123-042	Temporary construction plug, plastic for functions

Available in 606 and 626 finish only. Everest C123 keyway standard.

Full Size Interchangeable Cores

Number	Description
23-030	Conventional core
20-740-XP	Primus XP high security core
N123-127	FSIC Driver

Available 606 and 626 finish only. Everest C123 keyway standard.

Primus XP High Security Cylinders

Primus XP cylinders are recommended for upgrading existing Classic key systems. Due to its extended patent life, the newly designed Everest Primus is recommended for new key systems and for upgrading existing Everest® key systems. Specify keyway to differentiate between Everest and Classic. Example: CP (Classic) vs. C123 (Everest).

See Schlage Cylinders, Keys and Key Control Catalog (SC-5293) for more details.

Small Format Interchangeable Core 8

Available in all lever designs, the SFIC (small format IC) option is designed for Schlage Everest® B Family Restricted keyway cores and is also compatible with other small format interchangeable cores.

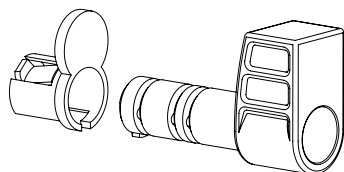

Disposable Construction Core



Small Format Interchangeable Cores

Number	Description
80-036	7-Pin uncombined Everest B Family Restricted keyways
80-037	7-Pin combined Everest B Family Restricted keyways
80-043	6-pin uncombined Falcon / Best keyways - all keyways
80-033	7-pin uncombined Falcon / Best keyways - all keyways
M204-152*	Disposable plastic construction core
N523-091	SFIC Driver
D500-000	Spacer for 6-pin cores

Available 606 and 626 , 613 (simulated) finish only. Specify keyway for existing systems.

80-033 and 80-043 cores are available in Best A, D, E, F, G, H, J, K, L, and M keyways. Specify keyway by suffixing "B" to keyway letter, e.g. "AB".

80-036 and 80-037 Restricted keyway cores require a letter of authorization from the end user. Schlage assigns the keyway when establishing new Everest Restricted key systems.

*M204-152 does not have a finish option.

Latches

ND-Series latches are adjustable for flat or beveled edge doors. Latches and strikes are furnished in brass, bronze, or chrome finishes to be compatible with lock trim. When ordering, specify quantity, part number, and finish. All ND-Series latches have 1/2" throw and 1" housings except 2 3/8" backset latches, which includes sleeve G506-815 to fill a 1" edge bore. Standard latches are shown in bold type.

Latches

Backset	Description	Deadlatch 1/2" (13 mm) Throw	Springlatch 1/2" (13 mm) Throw
2 3/8" (60 mm)	1 1/8" (29mm) x 2 1/4" (57mm) square corner	14-047	—
	1 1/8" (29mm) x 2 1/4" (57mm) square corner	14-048	—
2 3/4" (70 mm)	1 1/8" (29mm) x 2 1/4" (57mm), standard square corner	13-047	13-048
	1 1/8" (29mm) x 2 1/4" (57mm) throw, anti-friction door latch, square corner	14-042	—
3 3/4" (95 mm)	1 1/8" (29mm) x 2 1/4" (57mm), square corner	14-028	14-010
5"	Backset extension link	43-005	—

Deadlatch

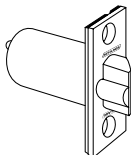

Springlatch

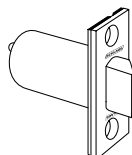

3/4" Throw Anti-Friction Deadlatch for Pairs of Fire Doors

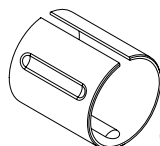
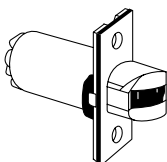

G506-815

Long Backsets

ND-Series locks with 5" backsets are normally furnished with 1 1/8" faceplates and 1" housings. Links installed in metal doors require one A501-567 sleeve and 43-005 (order separately) to join latch and link.

2 3/4" Latch

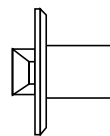

Extension Link (43-005)

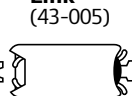

Sleeve (A501-567)

(add to 2 3/4" backset latch)



Door Reinforcement

Reinforcing unit is required to reinforce and help prevent the collapse of hollow metal doors when locksets are tightly mounted. This kit should be used with long backsets for ND-Series lock installations in hollow metal doors to prevent lateral movement of the latchbolt. Specify door thickness, 1 3/8" (35 mm) or 1 3/4" (44 mm), when ordering reinforcement kits.

Reinforcement Kit

37-001

Kit includes:

Reinforcement

A501-566 for 1 3/4" doors or
A501-565 for 1 3/8" doors

Sleeve

A501-567 for
5" backsets

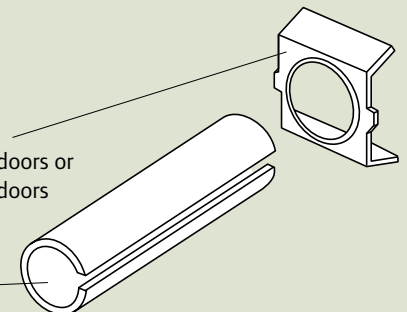

Strikes

All Schlage strikes are furnished complete with screws.

The standard ND-Series strike has a $1\frac{3}{16}$ " lip.

When ordering separately specify quantity, product number, finish, and lip length. Standard strikes are shown in bold type.

Strikes

Backset	Description	Lip Length
10-013	$1\frac{1}{8}$ " x $2\frac{3}{4}$ " (28mm x 70mm) Square corner, T-strike, box	$1\frac{1}{8}$ " (28mm)
10-016	$1\frac{1}{8}$ " x $2\frac{3}{4}$ " (28mm x 70mm) Square corner, T-strike, box	$1\frac{1}{2}$ " (38mm)
10-025	$1\frac{1}{4}$" x $4\frac{7}{8}$" (32mm x 124mm) Standard, no box, ANSI	$1\frac{3}{16}$" (30mm)
10-025	$1\frac{1}{4}$ " x $4\frac{7}{8}$ " (32mm x 124mm) ANSI, no box	$1\frac{3}{8}$ " (35mm)
K510-066	Box for 10-025 ANSI strike	—

ANSI Strike—Standard

(10-025)

$1\frac{1}{4}$ " x $4\frac{7}{8}$ " x $\frac{3}{32}$ "



Square Corner Box Strike

(10-013)

$1\frac{1}{8}$ " x $2\frac{3}{4}$ " x $\frac{3}{32}$ "

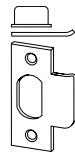

Rabbeted Latch and Strike Kit

Rabbeted latch and strike kit finishes: 605, 626.

This kit adapts square corner latches and $2\frac{3}{4}$ " (28mm) high strikes for $\frac{1}{2}$ " (13mm) rabbeted door and frame preparations.

Rabbeted Latch and Strike Kit

(39-030)

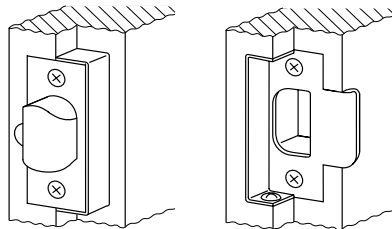

Accessories

$1\frac{3}{8}$ " D-Series Lever Door Spacer*



XN12-012

*For installation on $1\frac{3}{8}$ " doors, two (2) spacers are required. Specify finish.

Specifications

Handing:

All ND-Series lever locksets are non-handed.

Door Thickness:

15/8" to 2 1/8" (41mm–54mm) standard including Vandlgard® functions. 1 3/4" – 2" for function D85. See accessories (Page 21) for spacers required for 1 3/8" doors.

Backset:

2 3/4" (70 mm) standard. 2 3/8", 3 3/4" and 5" (60 mm, 95 mm, 127 mm) optional.

Faceplate:

Brass, bronze or stainless steel. 1 1/8" x 2 1/4" (29 mm x 57mm) square corner, beveled.

Lock Chassis:

Zinc plated for corrosion resistance.

Latch Bolt:

Steel, 1/2" (12mm) throw, deadlocking on keyed and exterior functions. 3/4" (19 mm) throw anti-friction latch available for pairs of fire doors.

Exposed Trim:

Levers: Pressure cast zinc, plated to match finish symbols.
Roses: Brass, bronze or zinc.

Strike:

ANSI curved lip strike 1 1/4" x 4 7/8" x 1 3/16" lip to center standard. Optional strikes, lip lengths and ANSI strike box available. See page 21.

Cylinder & Keys:

6-pin Everest C123 keyway standard with two patented nickel silver keys per lock.

Keying Options:

Interchangeable core and Primus high security cylinders.
Master keying, grand master keying and construction keying.

Warranty:

Seven-year limited for all functions including Vandlgard.

Certifications

ANSI:

Meets or exceeds A156.2 Series 4000, Grade 1 strength and operational requirements. Meets A117.1 Accessibility Code.

Federal:

Meets FF-H-106C Series 161.

California State Reference Code:

(Formerly Title 19, California State Fire Marshal Standard)

All levers with less than 1/2" (64mm) returns comply; Schlage levers return to within 1/2" of door face.

MEA Certification:

All electrified locking (fail-safe, unlocked by switch or power failures) functions accepted for use in New York City by the City of New York, Department of Buildings (MEA 24-04-E).

All levers with less than 1/2" (64mm) returns comply with California Fire Safety Codes.

Florida Building Commission:

3/4" and 1/2" throw latch approved for Hurricane Resistance with Miami-Dade County, Florida.

UL / cUL:

All locks listed for A label single doors, 4' x 8'.
Letter F and UL symbol.

ADA Compliant:

Schlage Lock Company offers a wide selection of locks designed to meet the Americans With Disabilities Act.

Door Preparation

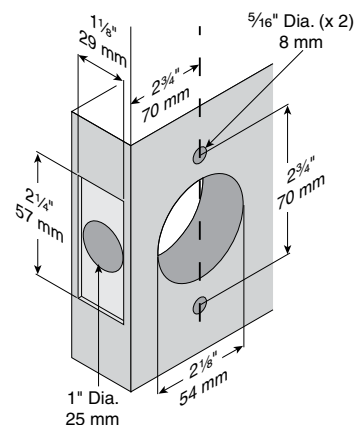



Ordering Guidelines

To order Schlage products, descriptive data should be in the same sequence as shown.

Line Item	Qty	Product	Outside		Inside		Hand	Latch	Strike	DR Thk	Ext	Dim	Additional Details
			Des	Fin	Des	Fin							
1	2	3	4	5	6	7	8	9	10	11	12	13	14

- 1 Line item number
- 2 Quantity
- 3 Complete model number with function and cylinder type

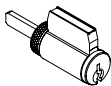
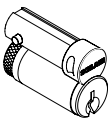
To order cylinder options, change "PD" at the end of the model number as follows:

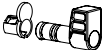
	ND53PD	Standard.
	ND53LD	Less standard cylinder. For Primus cylinder, specify this option and order Primus cylinder separately.
	ND53CD	With temporary plastic construction cylinder. Double cylinder functions ordered <i>less cylinder</i> are furnished with these construction cylinders to maintain timing of key cams.
	ND53JD	Prepared for full size interchangeable core, less core. For Primus core, specify this option and order Primus core separately.
	ND53RD	With full size conventional interchangeable core installed. Order control keys separately.
	ND53TD	With full size (temporary) construction core installed. Order all keys separately.
	ND53BD	Prepared for small format interchangeable core (SFIC), less core.
	ND53GD	With Everest B Family restricted keyway small format core installed. Order control keys separately.
	ND53HD	With small format keyed brass construction core installed. Order all keys separately.
	ND53BDC	With small format disposable plastic construction core installed.

- 4 / 5 Outside design / finish. Specify tactile warning here as "8AT" for Athens, "8RO" for Rhodes, "8SP" for Sparta or "8TR" for knurling on Tubular
- 6 / 7 Inside design / finish. Leave blank if same as outside.
- 8 Hand. Required for keyed knob designs and all split finish locksets. One hand per line item.
- 9 Latch. Leave blank for standard or specify part number for optional latch. LLL=Less Latch.
- 10 Strike. Leave blank for standard or specify part number for optional strike. LLL=Less Strike.
- 11 Door thickness, if non-standard. Example: 200 = 2".
- 12 Extension, to specify whether thick door is extended inside (EI), outside (EO), differently (ED) or equally (EE).
- 13 Dimension for strike lip lengths. See price book for availability of specific dimensions with specific strikes (e.g. 138 = 1³/₈).
- 14 Keying detail (e.g. key symbol, keyway, bitting) and other special requirements.

Example

Line Item	Qty	Product	Outside		Inside		Hand	Latch	Strike	DR Thk	Ext	Dim	Additional Details
			Des	Fin	Des	Fin							
1	24	ND10S	SPA	605					10-013	214	EE		1AA-100AA
2	4	ND50RD	RHO	613								138	C145 245793
3	60	ND93PD	ATH	626				14-047					E 000000

Note: Schlage order forms are available at no charge by contacting your sales representative or by visiting schlage.com.



Ingersoll Rand's Security Technologies Sector is a leading global provider of products and services that make environments safe, secure and productive. The Sector's market-leading products include electronic and biometric access control systems; time and attendance and personnel scheduling systems; mechanical locks and portable security, door closers and exit devices, steel doors and frames, architectural hardware and technologies and services for global security markets.

www.ingersollrand.com